

EAL307SWC - Specification Sheet

Land Rover Defender Spare Wheel Cradle

1. MANUFACTURER DETAILS

Safety Devices International Ltd
Cambridge House
Holborn Avenue
Mildenhall
Suffolk
IP28 7AN
United Kingdom

TEL. NO: +44 (0) 1638 713606
E-MAIL: expedition@safetydevices.com

2. VEHICLE FOR WHICH SPARE WHEEL CRADLE IS DESIGNED

MAKE: LAND ROVER
MODEL(s): DEFENDER (L663)
GROSS VEHICLE WEIGHT: VARIOUS

3. SPARE WHEEL CRADLE MATERIAL DETAILS

	All tube unless stated	Brace Tube
Material	EN 10305 E220 / ERW	EN 10305 E220 / ERW
External diameter	32mm	25mm
Wall thickness	2.5mm	2mm
Yield	220 N/mm ²	220 N/mm ²
Tensile strength	310 N/mm ²	310 N/mm ²

4. SPARE WHEEL CRADLE WEIGHT

WEIGHT OF LADDER AND FITTINGS: 2.5 (kg)

5. DRAWING OF SPARE WHEEL CRADLE

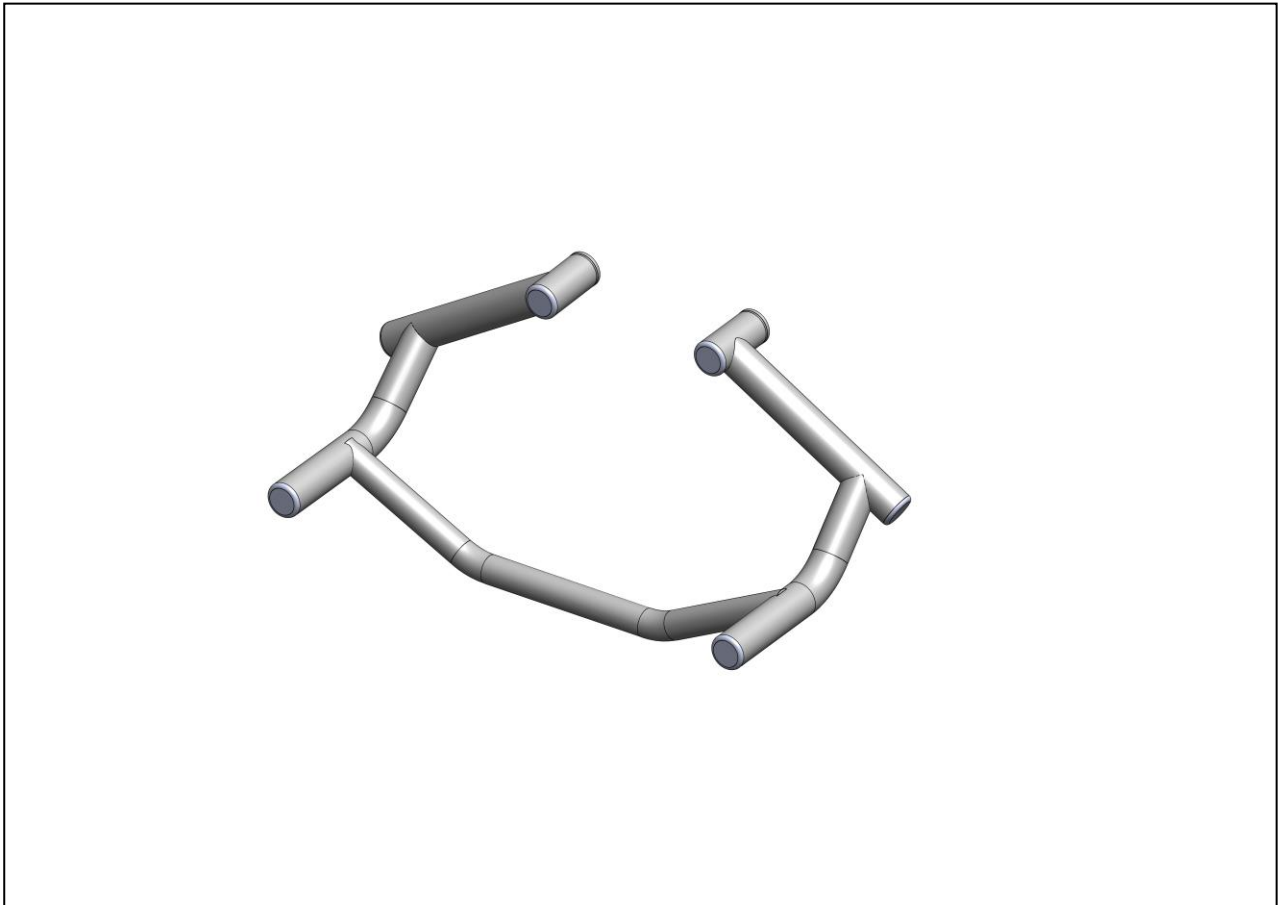

6. DECLARATION BY MANUFACTURER

I certify that the Spare Wheel Cradle described herein is manufactured to the specification laid out in this document.

DATE: 10/09/24

NAME: Aeron Lloyd

SIGNATURE:

STATUS: Managing Director